

# Aluminum Frame of 17 mm

## Necessary tools for assembling and installing

### Supplied materials (included):

- 4 extrusions
- 4 connectors for corners
- Mounting bracket(s)
- 1 Allen key
- 1 fabric print

### Other necessary tools (not included):

- Drill
- Screwdriver
- Screws adapted to your wall
- Plastic anchors (for gypsum wall)



## Assembly

### Assembling the frame:



**1.** Position flat on a table the four extrusions of the frame's sides in order to form the frame.

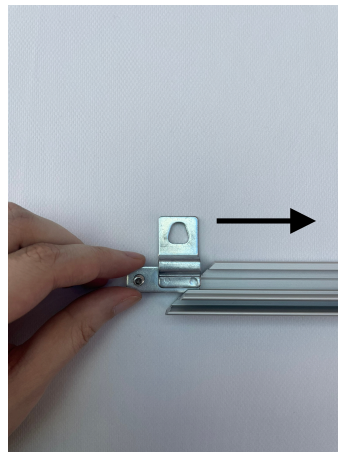

**2.** Insert and slide the mounting bracket(s) on the extrusions so that they will be evenly distributed to secure the frame onto the wall.

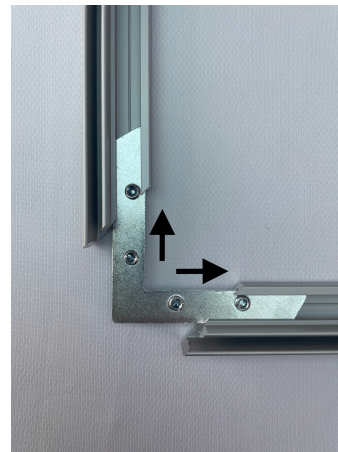

**3.** Insert one connectors at each corner, by sliding it into the groove of the extrusion.

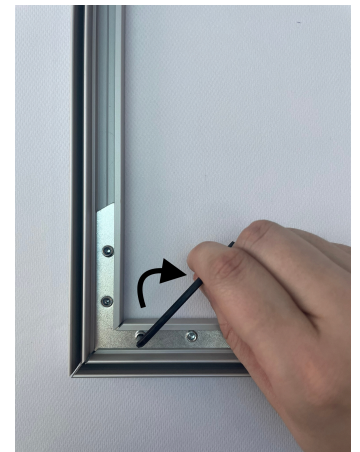

**4.** Assemble all the frame, then securely screw each junction using the Allen key.

## Installation

Installing the frame on the wall:



**1.** Place the frame against the wall. Position the bracket(s) evenly to ensure a well-distributed mounting system to support the weight and position of the frame securely onto the wall.



**2.** Attach the frame onto the wall by fastening the screws adapted to your wall into the bracket(s). For a gypsum wall, we suggest to use plastic anchors before fastening the screws to secure the frame to the wall.

## Fabric Print

Mounting the fabric print in the frame:

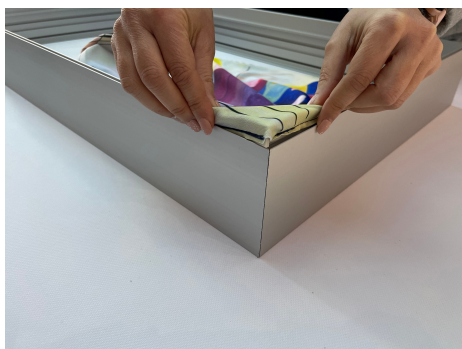

**1.** Take one corner of the fabric print and insert the silicone edge trim into the slot of the frame. Put this way each corner of the fabric print in the frame.



**2.** Push in the central part of the silicone edge trim on each of the four sides.



**3.** Finish by smoothing the perimeter of the fabric print so that the silicone is pressed evenly all over.

**Note:** To remove the fabric print, pull on the label for it to easily come off the frame.